

NOTE
 ALL DIMENSIONS TO BE CHECKED ON SITE
 NO DIMENSIONS TO BE SCALED FROM THIS DRAWING
 THIS DRAWING IS TO BE READ IN CONJUNCTION WITH
 RELEVANT CONSULTANTS DRAWINGS
 NO PART OF THIS DOCUMENT MAY BE REPRODUCED OR
 TRANSMITTED IN ANY FORM OR STORED IN ANY RETRIEVAL
 SYSTEM OR ANY MANNER WITHOUT THE WRITTEN PERMISSION
 OF THE LANDSCAPE ARCHITECT AS COPYRIGHT HOLDER EXCEPT
 AS AGREED FOR USE ON THE PROJECT FOR WHICH THE
 DOCUMENT WAS ORIGINALLY ISSUED
 FOR DRAWING INDEX GENERAL NOTES REFER TO
 DWG L1-001

CLIENT:

CWTC Multi Family ICAV

ARCHITECTS:
HENRY J LYONS ARCHITECTS

LEGEND

| | | | |
|--|-------------------------------|--|--|
| | PLANNING APPLICATION BOUNDARY | | EDGE PAVING |
| | APPLICANT OWNERSHIP | | SOFT PAVE PLAYGROUND |
| | PUBLIC REALM PAVING | | SOFT PAVE PAVEMENT |
| | SHARED SURFACE | | COURTYARD SETTS |
| | PAVING PAVING | | PAVING BANDS |
| | GRAVEL PAVING | | PUBLIC OPEN SPACE PAVING |
| | PRIVATE AMENITY SPACE PAVING | | FEATURE PAVING |
| | COURTYARD PAVING | | ASPHALT TUFFES TO UNDERGROUND CARPARK |
| | HEDGE PLANTING | | VENTILATION GRATE TO UNDERGROUND CARPARK |
| | SHRUB | | SOFT TACTILE PAVING TO STAIRS |
| | LAWN | | SOFT TACTILE PAVING TO STAIRS |
| | BOLLARD | | TREE GRILLE |
| | BIKE STAND | | TREE LOCATION TO COURTYARD |
| | PRESTAN BENCH | | LETTER BIN TO PUBLIC DOMAIN |
| | DRINKING FOUNTAIN | | LETTER BIN TO PUBLIC DOMAIN |
| | PRIVATE AMENITY SPACE | | ACCESS GATES |
| | BASEMENT LINE | | STEPS WITH HANDRAILS AND TACTILE PAVING |

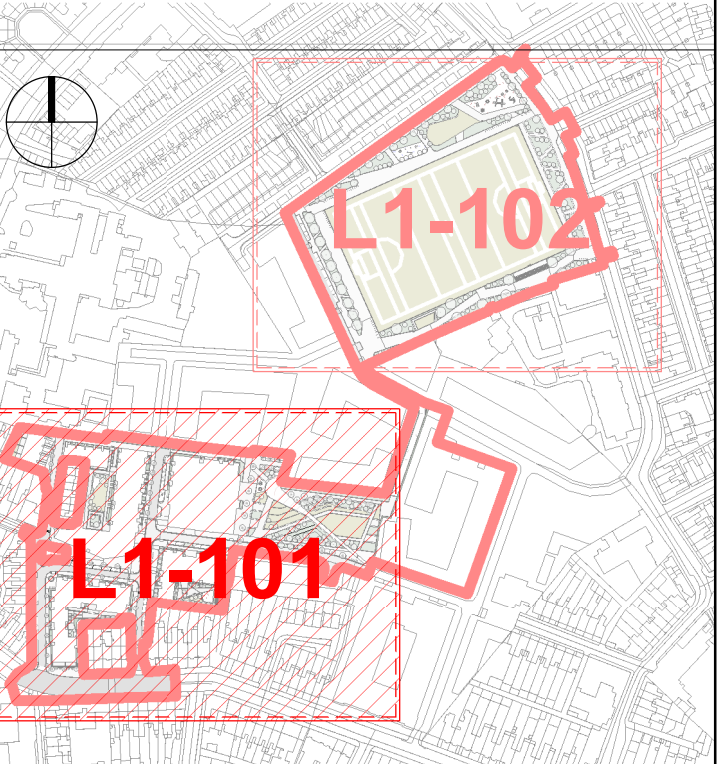
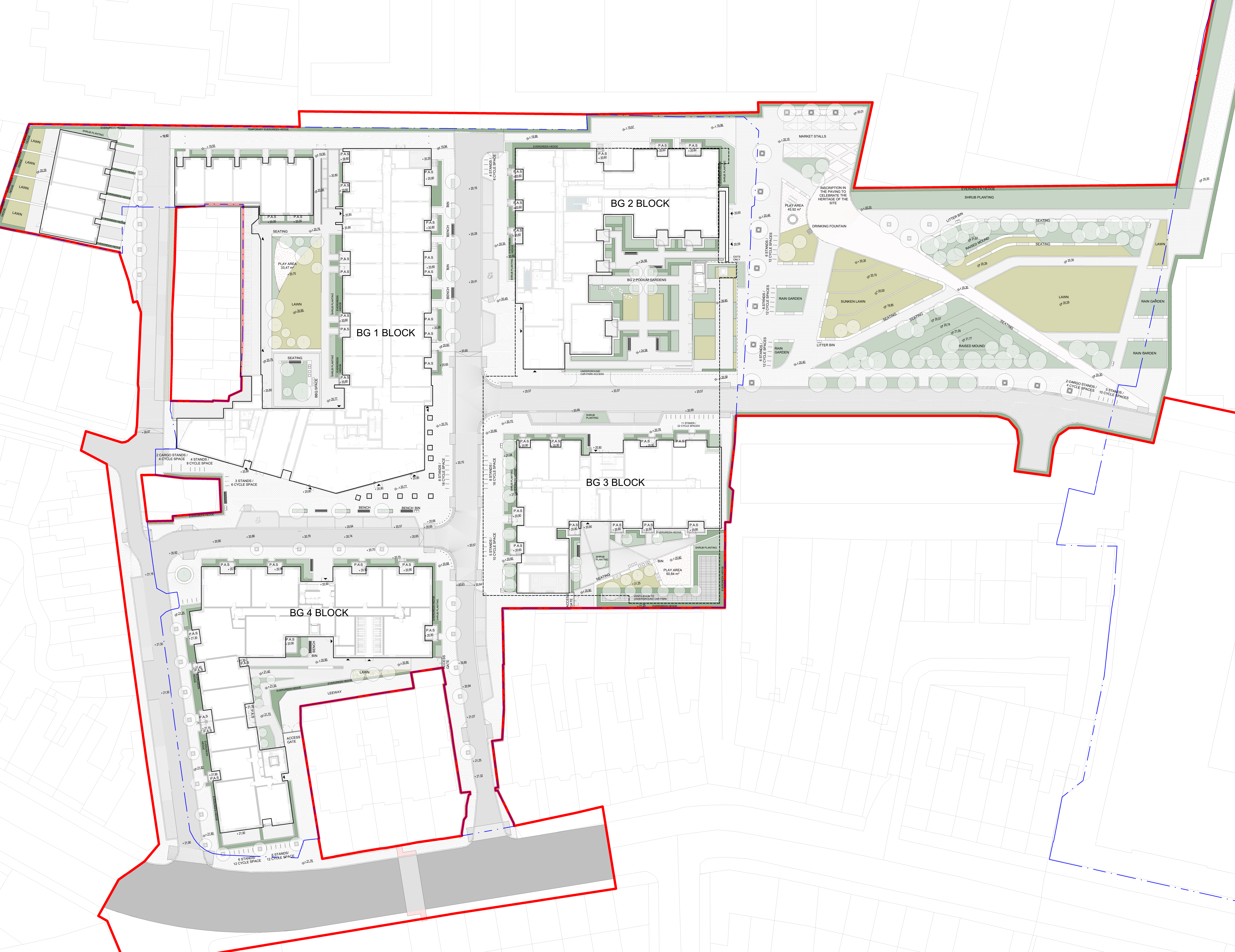

REFERENCE: THIS DRAWING IS NOT FOR CONSTRUCTION

FILE NAME:

| | | |
|----|-----------------|---------|
| 02 | FOR INFORMATION | 06/2022 |
| 01 | FOR INFORMATION | 01/2022 |
| 00 | FOR INFORMATION | 11/2021 |

REVISIONS

| | | | |
|---------|------------|------------|----------|
| Job No. | 13ABA | Drawn By | KFR |
| Dwg No. | L1-101 | Checked By | HDL |
| Scale | 1:250 @ A0 | Date | JUN 2022 |

JOB DESCRIPTION
 Client: APPLICANT DBTR-SCR1 FUND
 Project: BAILEY GIBSON SHD 2
 Title: LANDSCAPE PLAN - SHEET 1 OF 2

NMP
 Neil Montgomery Partners
 Architects 33 Rock Road, Willemstown, Blackrock, Co. Dublin
 Telephone: 2121 800 Fax: 2121 007 E-mail: info@nmp.ie